

THE KISS

The Kiss is an encounter between a book and a landscape. Between two wooden giants on a chessboard, two crowns like kings and queens moving together in a ballet of words. A festival is a cross-path between a place and different arts. It is under the wise eye of San Giuseppe, Sant'Agostino and the Torre dell'Orlogio, that this encounter takes place, facing the mediterranean horizon. The pavilion acts like a kinetic object, attracting curiosity to invite visitors to come closer.

Shelter for books and for humans, the Kiss is an assembly. Two distinct elements, sometimes polarised on the piazza, sometimes perceived as one contemporary object, in conversation with architecture. Just like a book, the pavilion is a container to be open, a sanctuary for thousands of stories. Not only is the Kiss a place to read other stories, it is a place of reunion. Conferences, interviews, even first kisses, can happen within it.

Conceived as a mini amphitheater, like a little brother for the Teatro Greco, the Kiss is a simple structure, made of 14 wooden batts bound together by circular shelves, and enclosed by an open-work skin giving it a visual porosity while offering a sensation of protection.

SITE PLAN & ELEVATIONS
SCALE 1:200

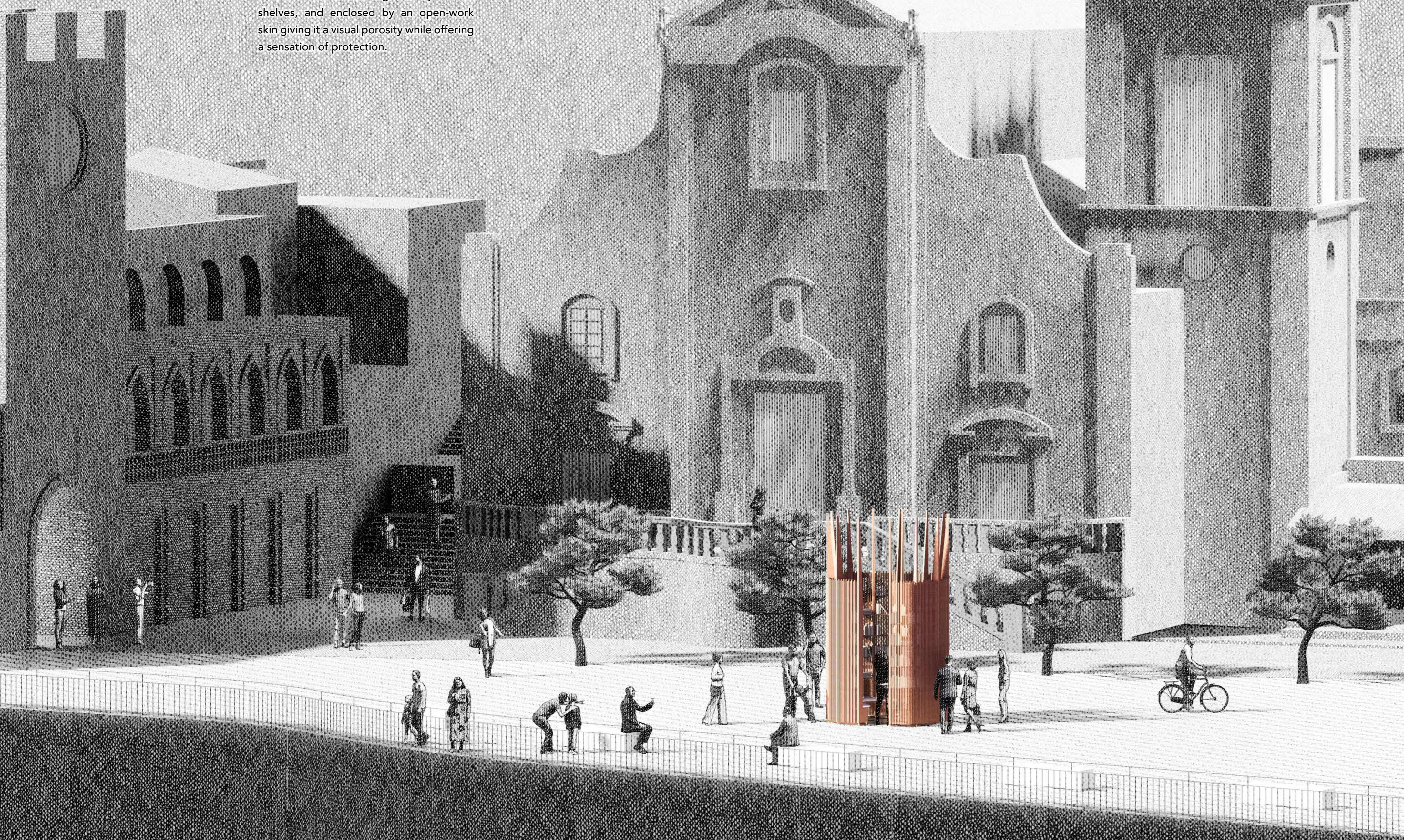

PERSPECTIVE VIEW - FOLDED SETUP

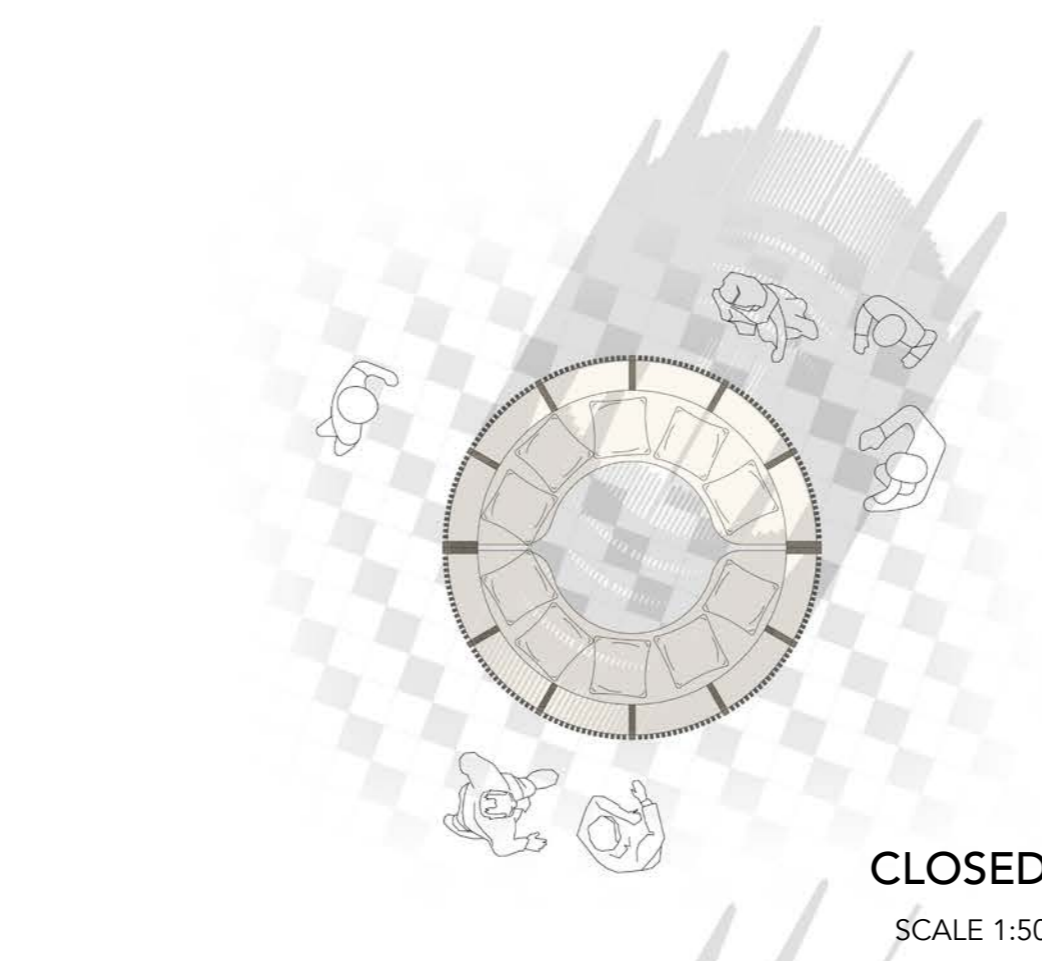

CLOSED
SCALE 1:50

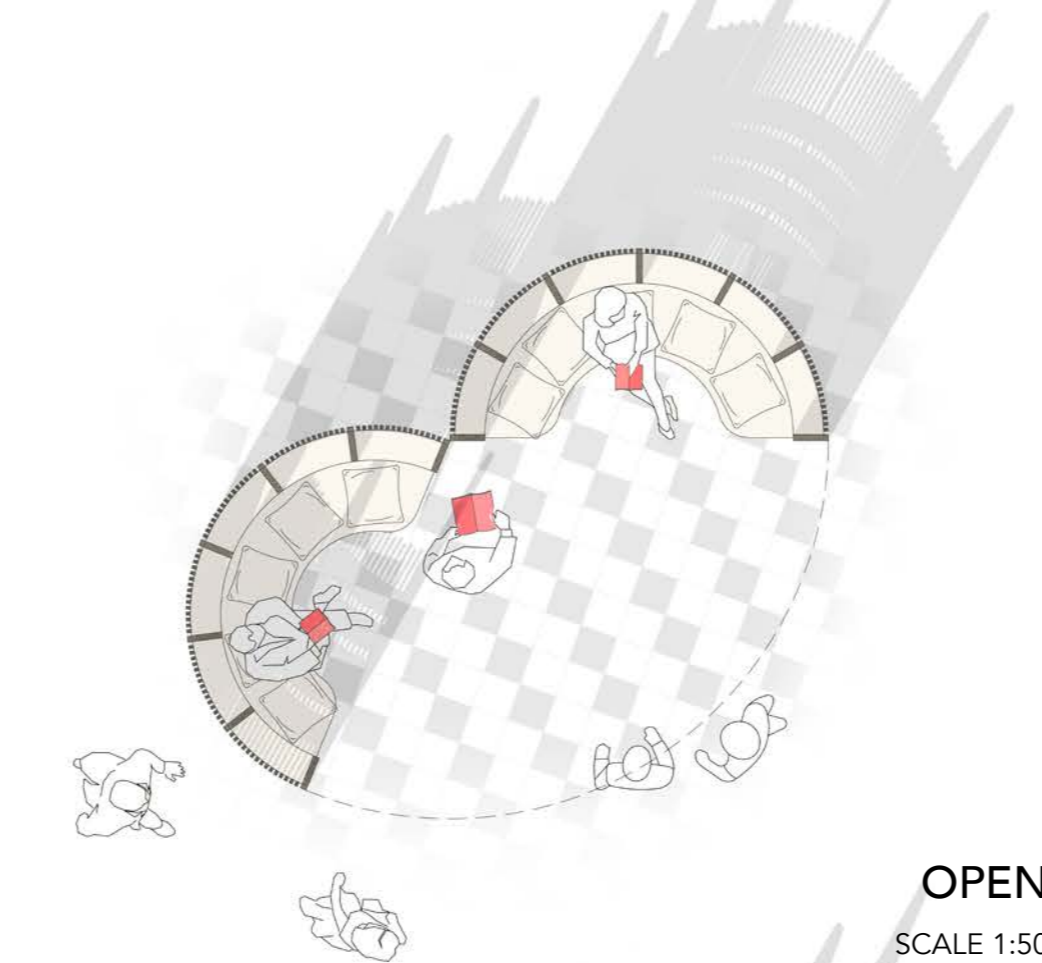

OPEN
SCALE 1:50

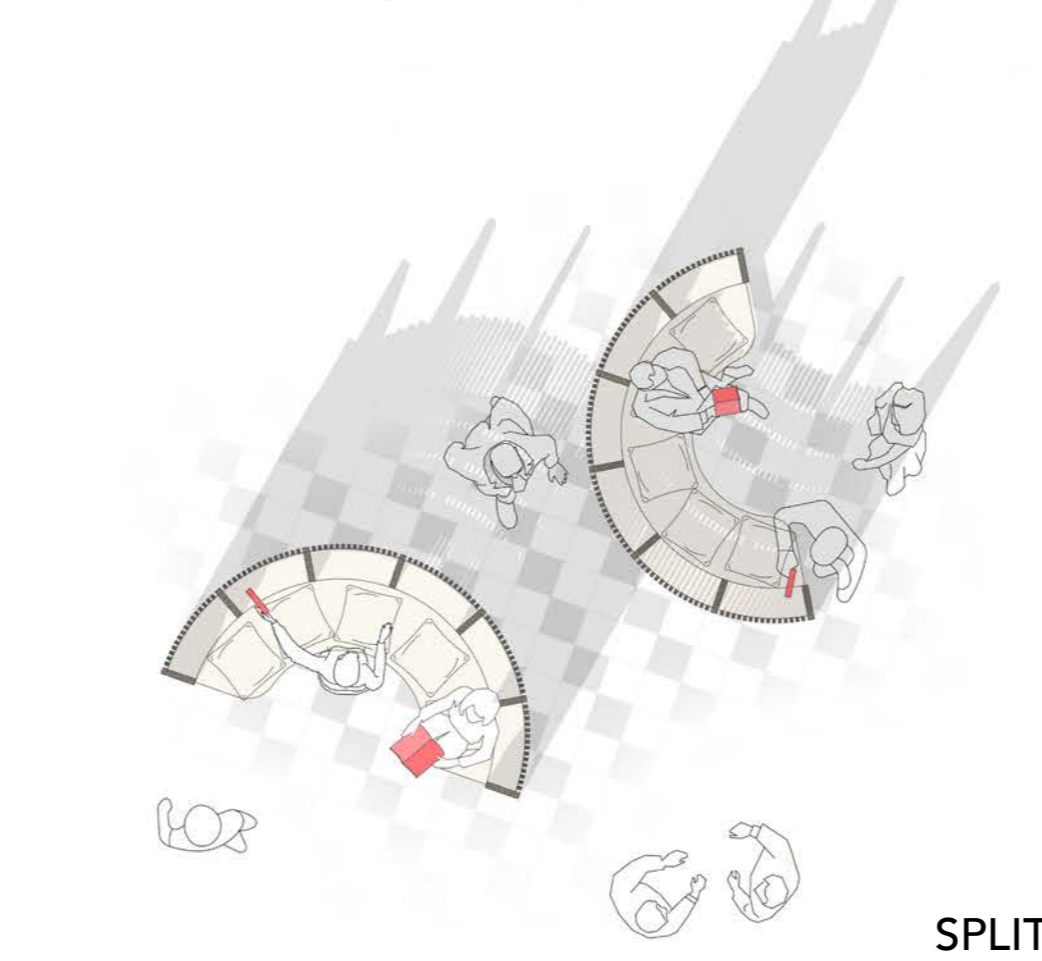

SPLIT
SCALE 1:50

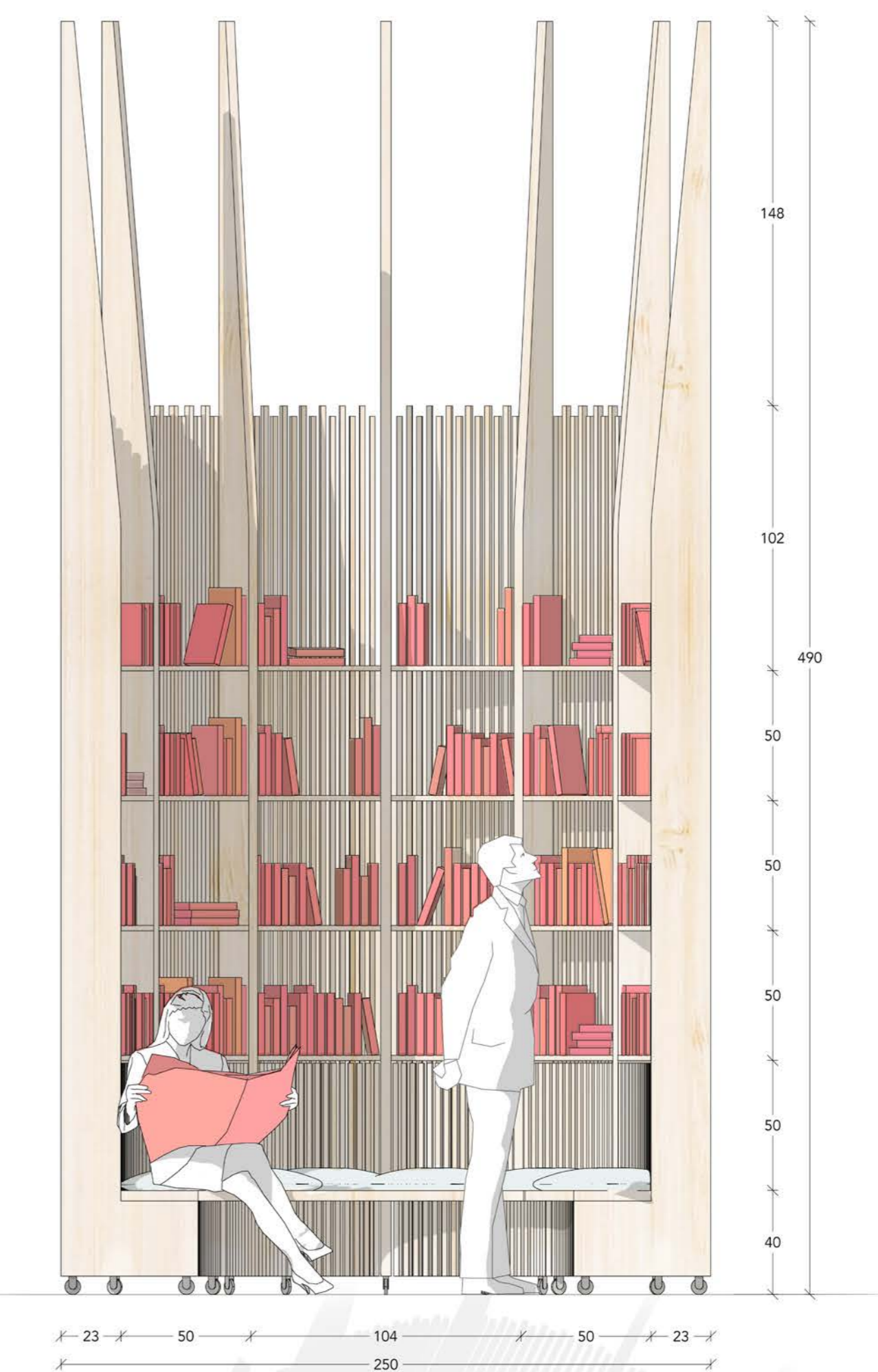

ELEVATION
SCALE 1:20

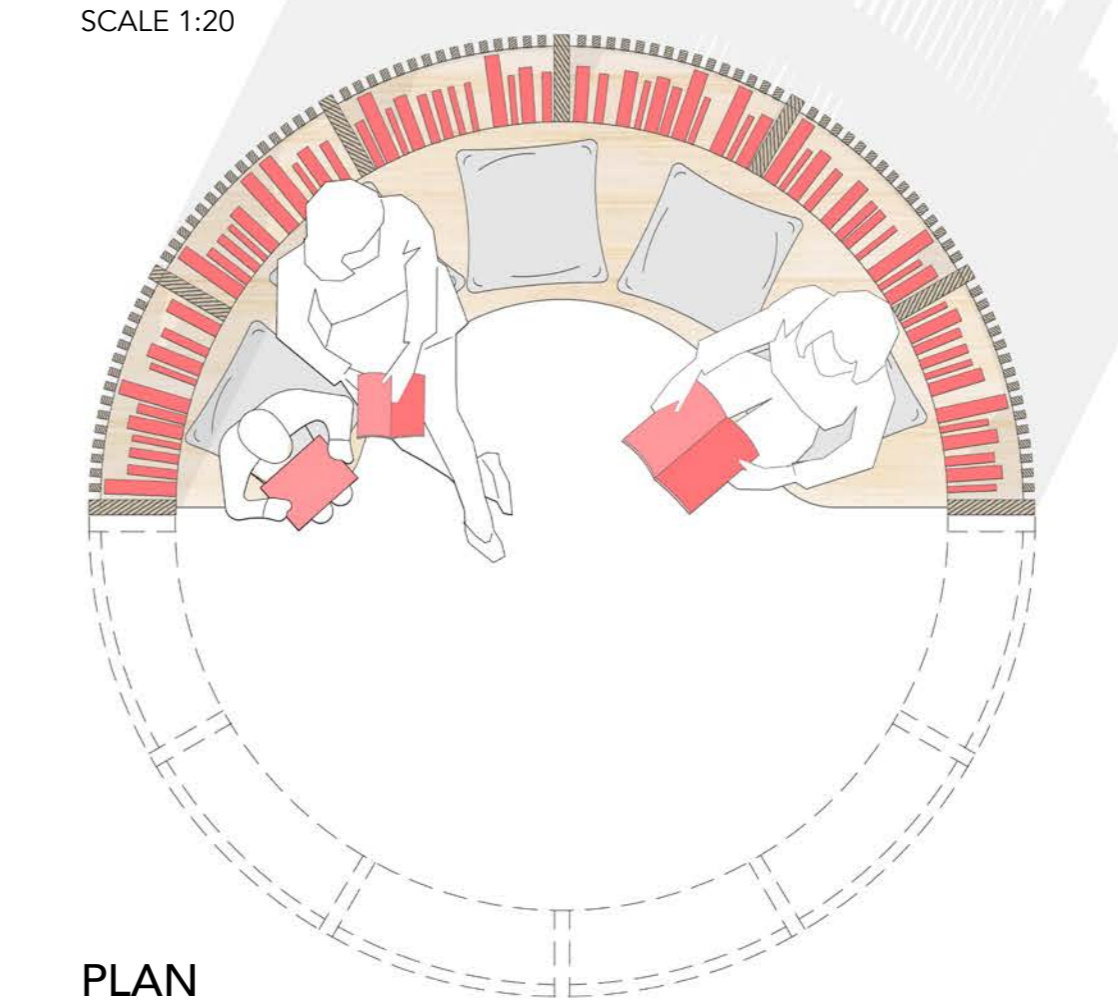

PLAN
SCALE 1:20

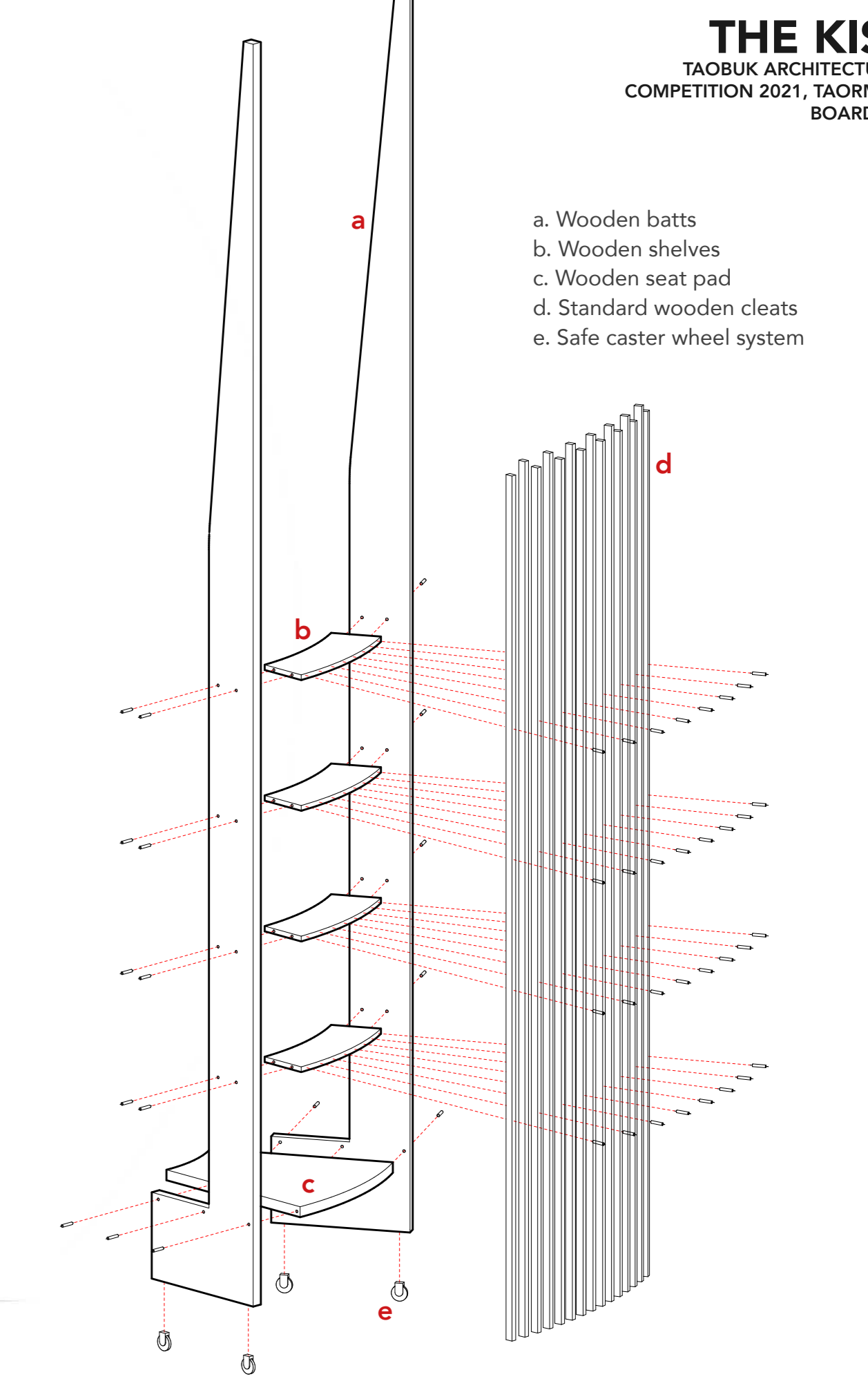

TYPICAL MODULE ASSEMBLY
SCALE 1:20

The pavilion is a \varnothing 2.5m circle, split in two parts that can either work together or separately. This way, different setups can take place on the piazza to create various scenes of conviviality and curiosity. Designed as a mini amphitheater, it invites people to shelter and sit surrounded by books. Structures are mounted on caster wheels to insure an easy use and displacement across the piazza.

Thanks to an open-work skin made of standard cleats of section 30x20mm directly screwed on the shelves, the structure allows the wind to pass through. The overall geometry guarantees stability and prevents the pavilion from falling. When assembled together, both half can easily be locked one to another for the night, and keep books safe.

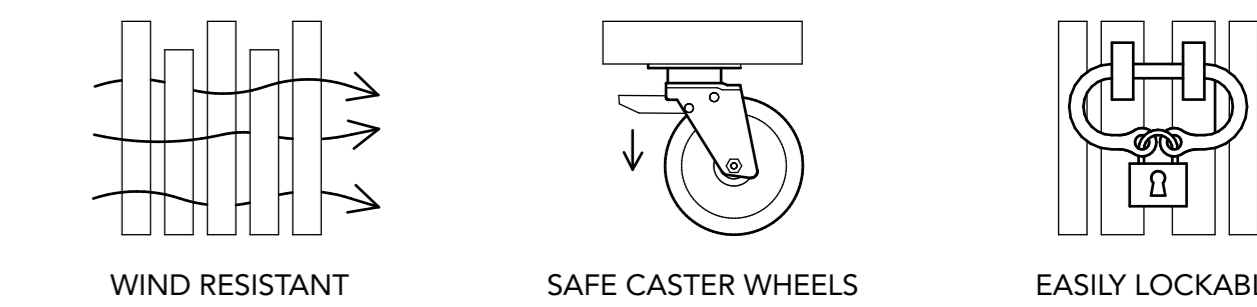

WIND RESISTANT SAFE CASTER WHEELS EASILY LOCKABLE



SPLIT SETUP

When split in two, the pavilion takes advantage of the piazza to spread and offer different orientations. Either isolated from the city to face the landscape, either in direct contact with the piazza, the amphitheater typology allows to play with different configurations.



OPEN SETUP

Convenient for scenery settings such as interviews, conferences or book signings. The unfolded structure creates a screen of books and orientates a stage setup, so that a public can easily be installed on the piazza.