

Territoires Exhumés/ Cour internationale de l'eau à Francfort sur Main

Laura Barbe

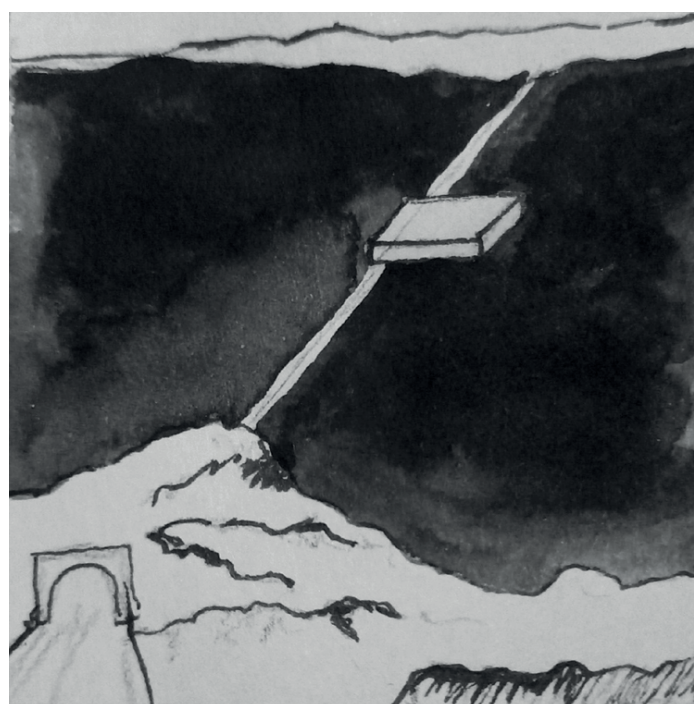

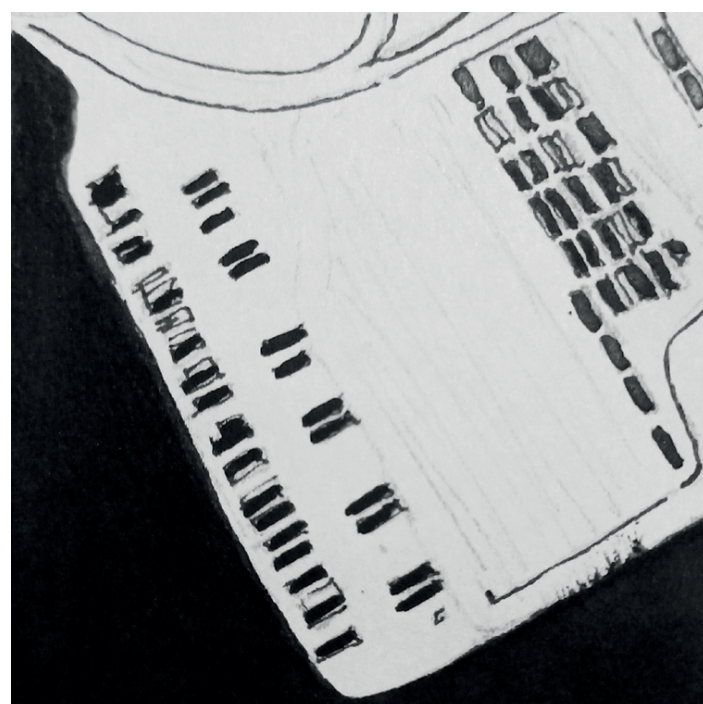
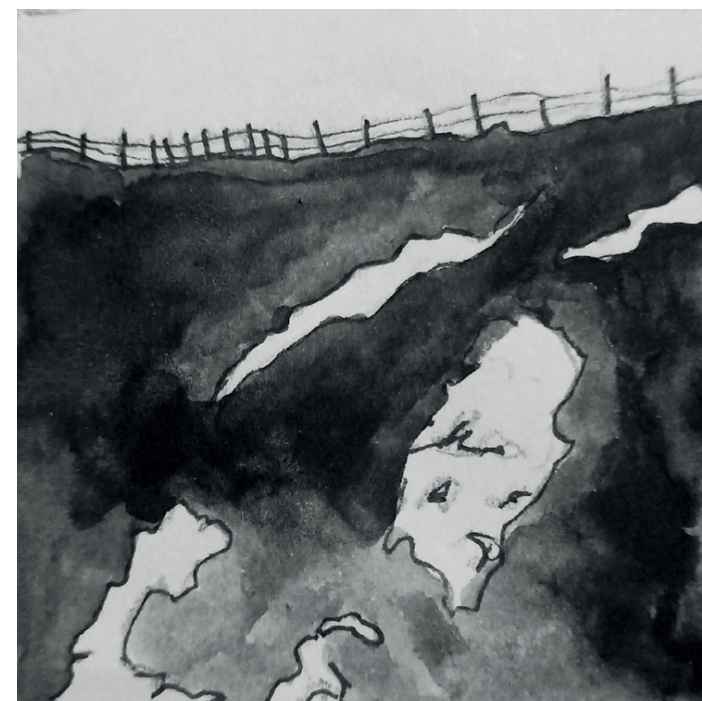
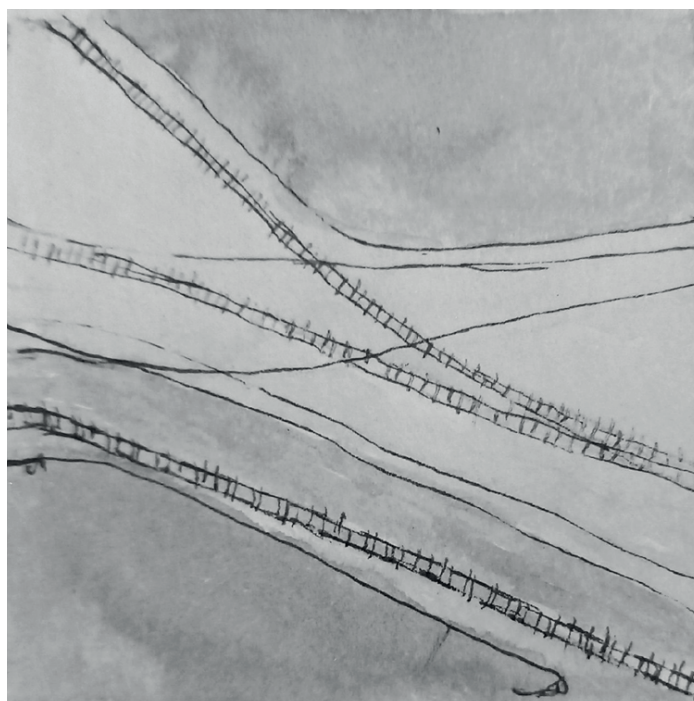
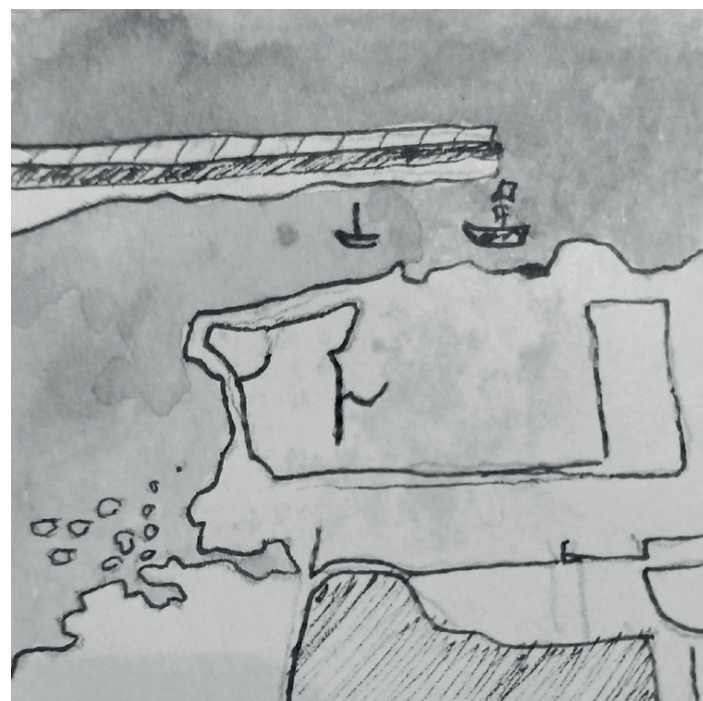

Diagramme des acteurs du fleuve Sénégal.



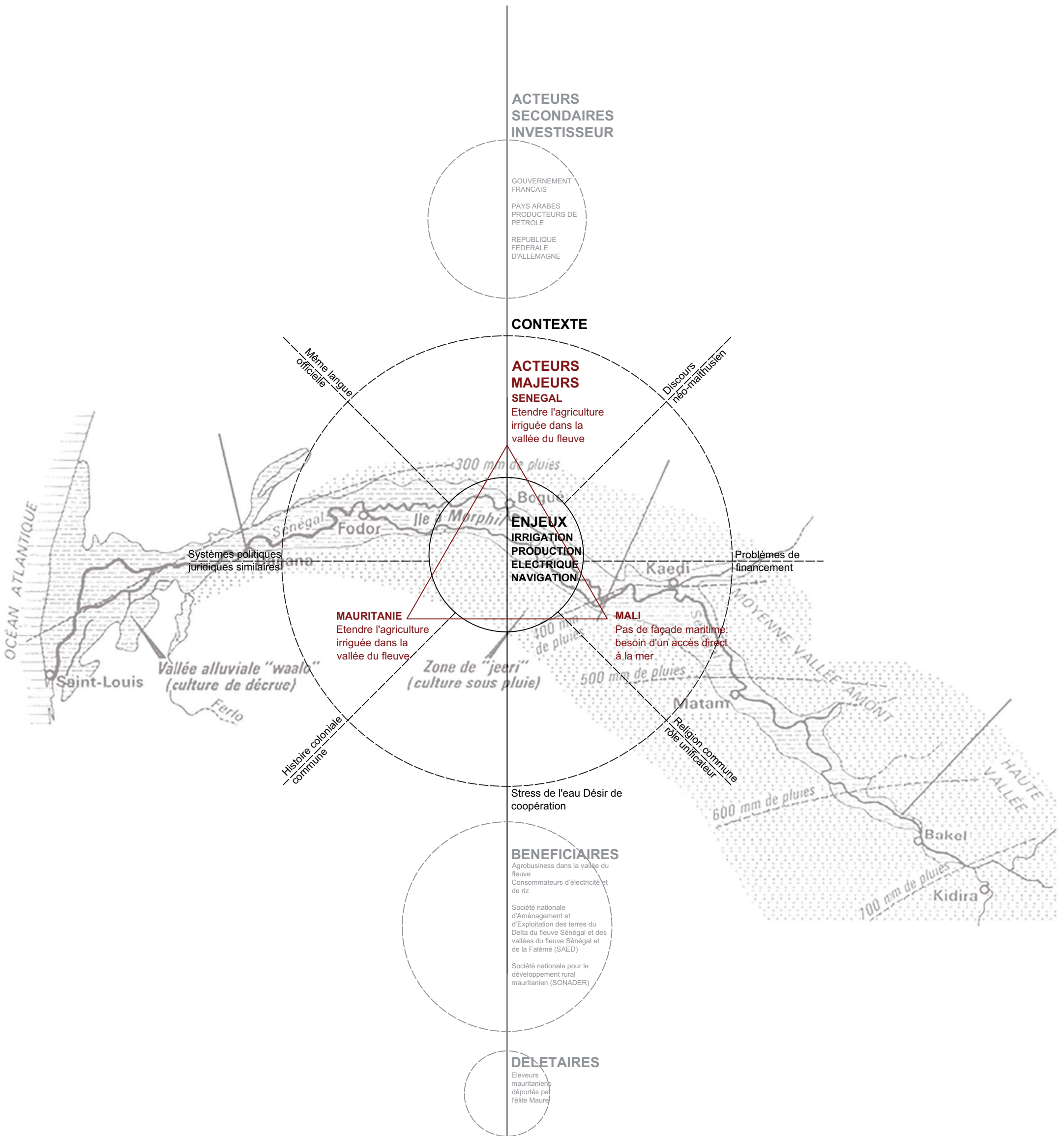
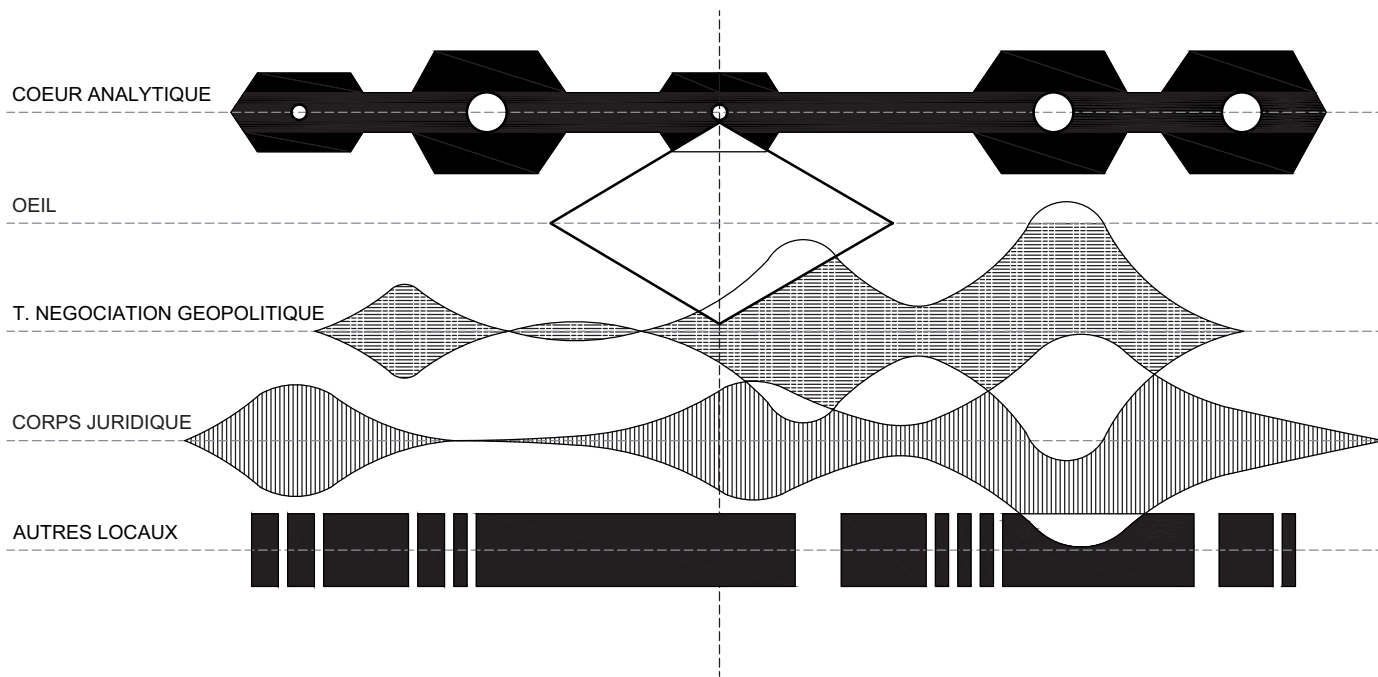
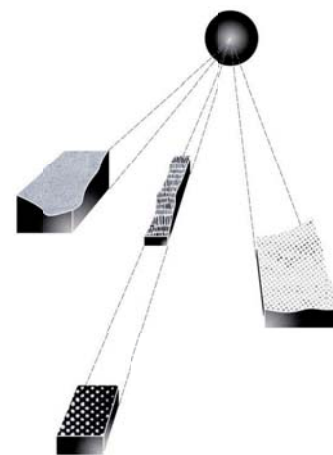
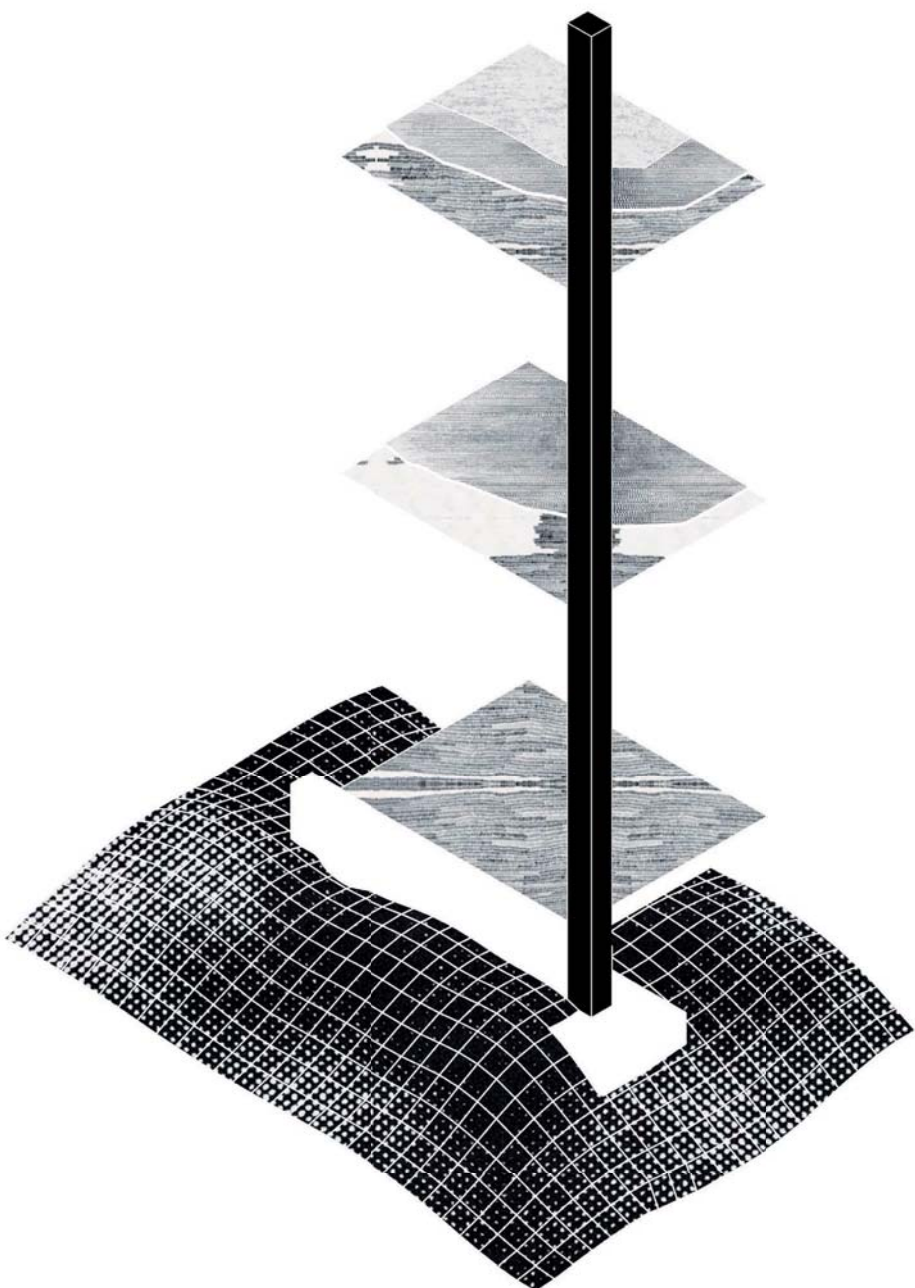
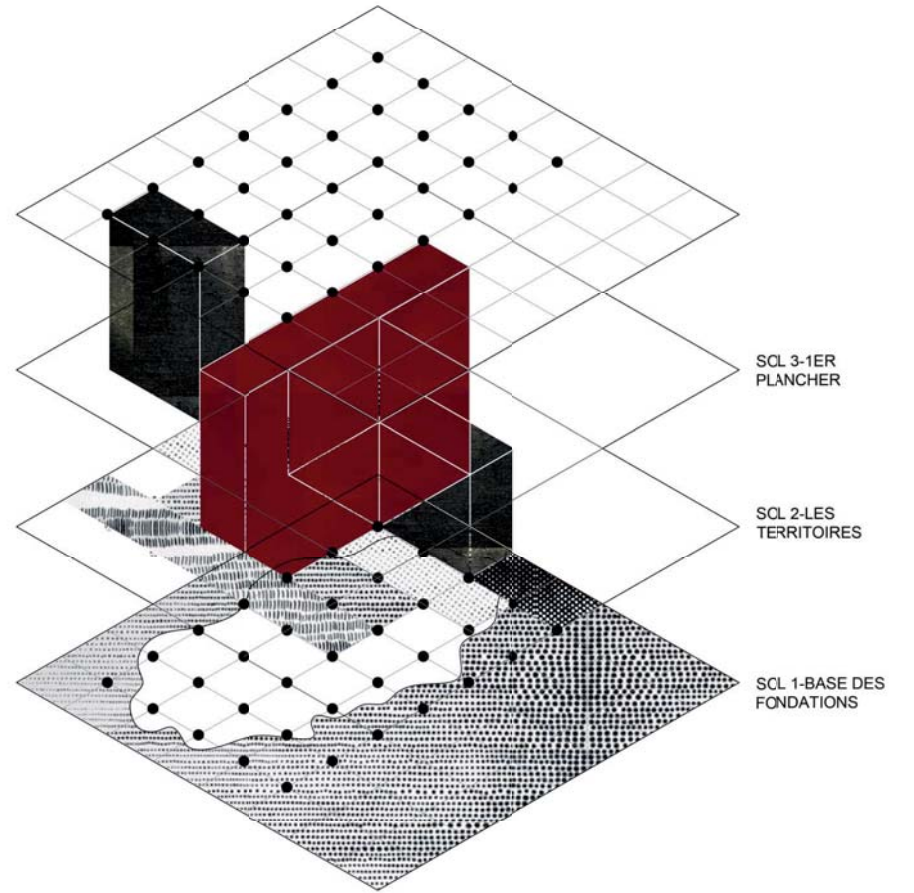

Territoires Exhumés/ Cour internationale de l'eau à Francfort sur Main

Laura Barbe

EAU ET AGRICULTURE-SOL

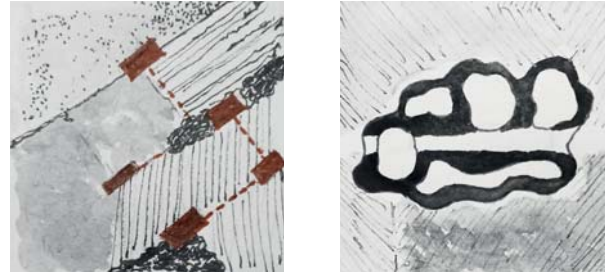
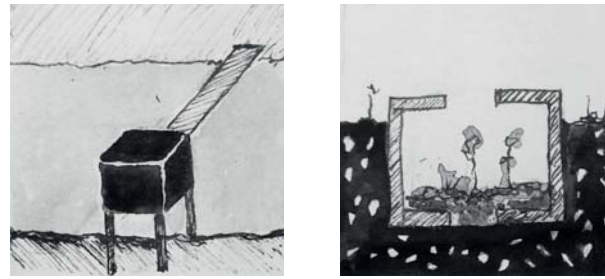

Aborder la frontière.

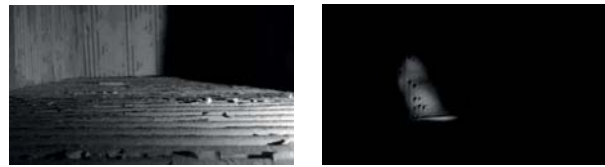

Atmosphères.

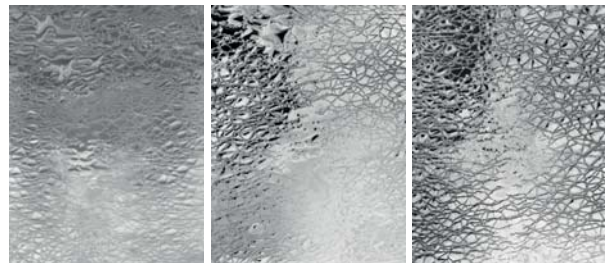
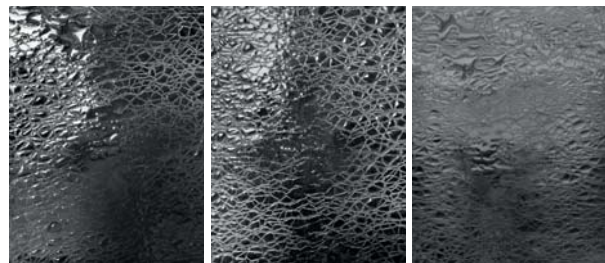

Reflections.

LE SILLON ET L'ANCRAGE



Cartographies des fortes fréquentations à Frankfurt qui fait apparaître l'ancienne fortification.

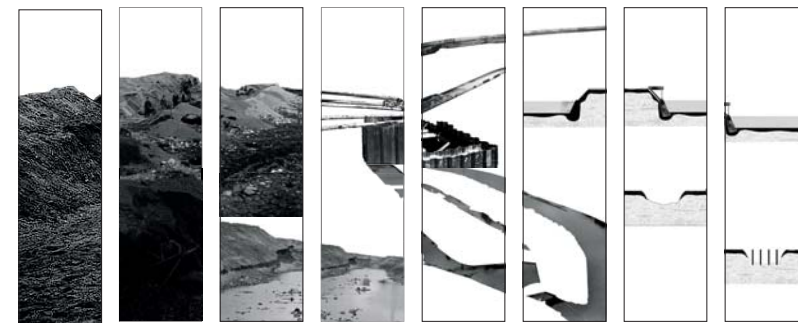

Construction du port de Francfort Osthafen dans les années 1920.

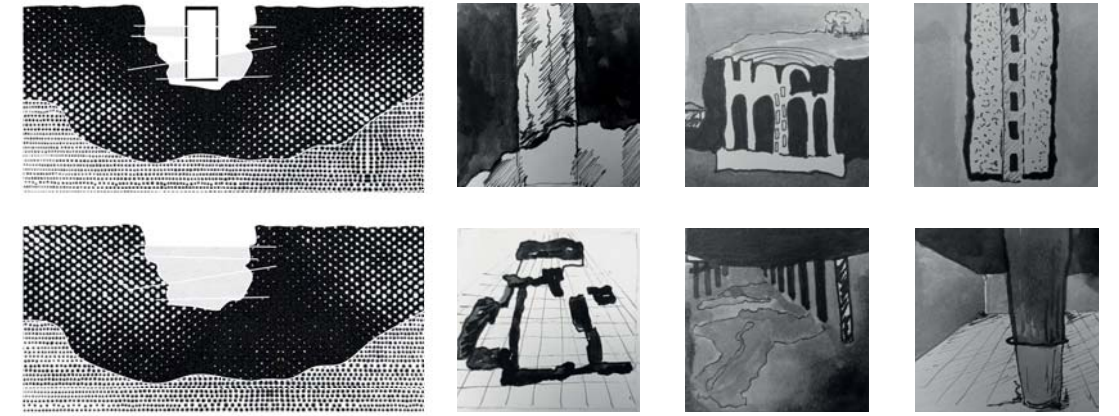

L'ancrage.

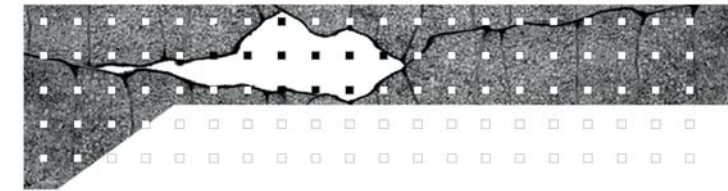

Sol 1-Base des fondations

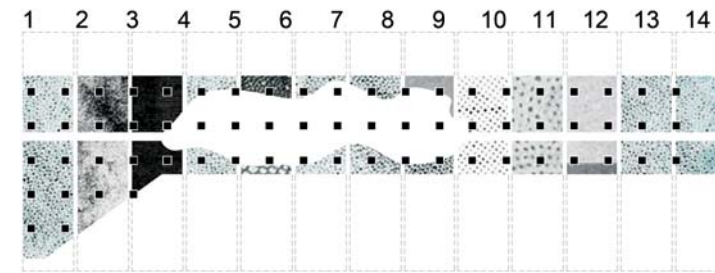

Sol 2-Les territoires alimentés



Sol 2-Les territoires

Territoires Exhumés/ Cour internationale de l'eau à Francfort sur Main

Laura Barbe

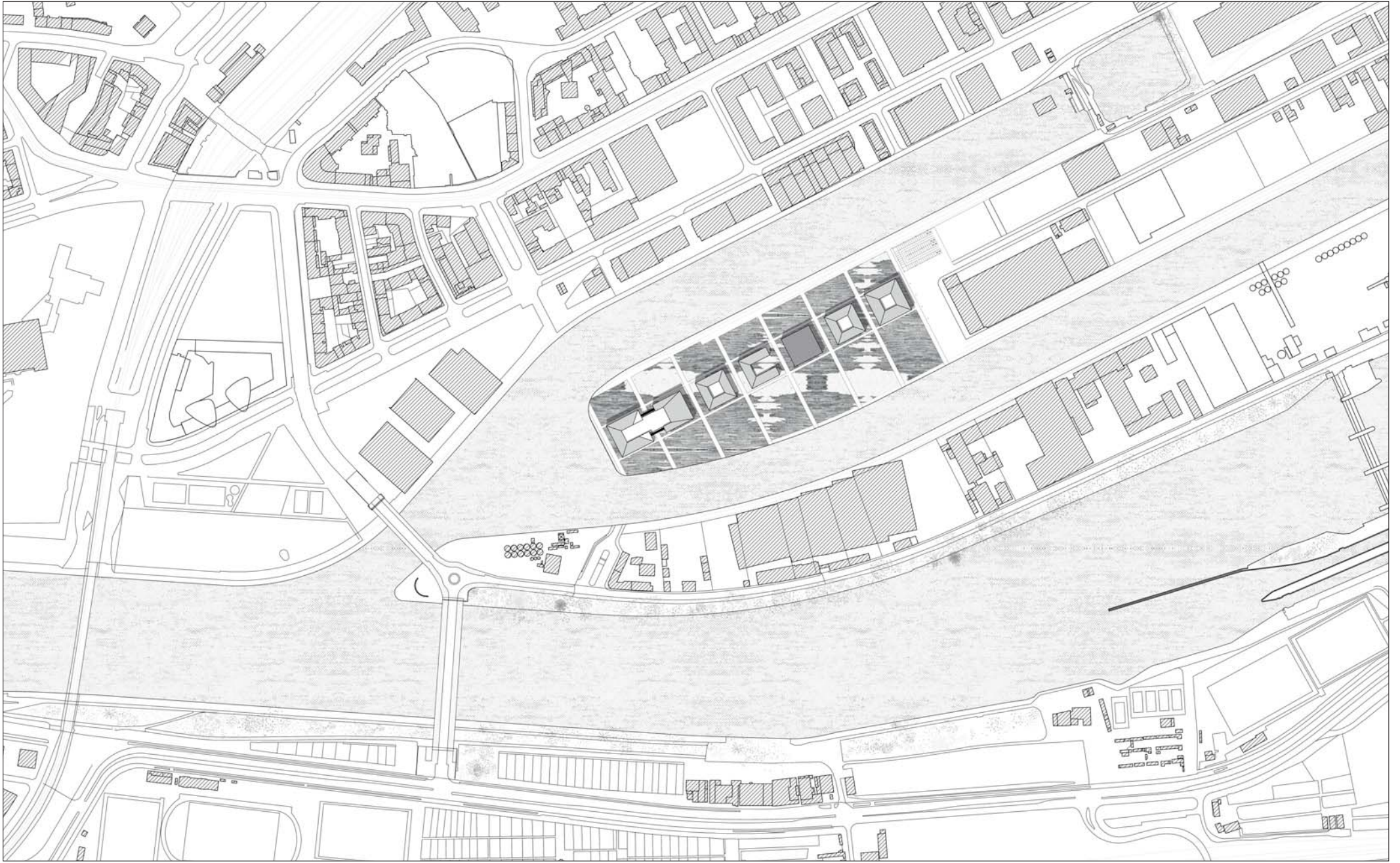

PLAN MASSE

1:2000

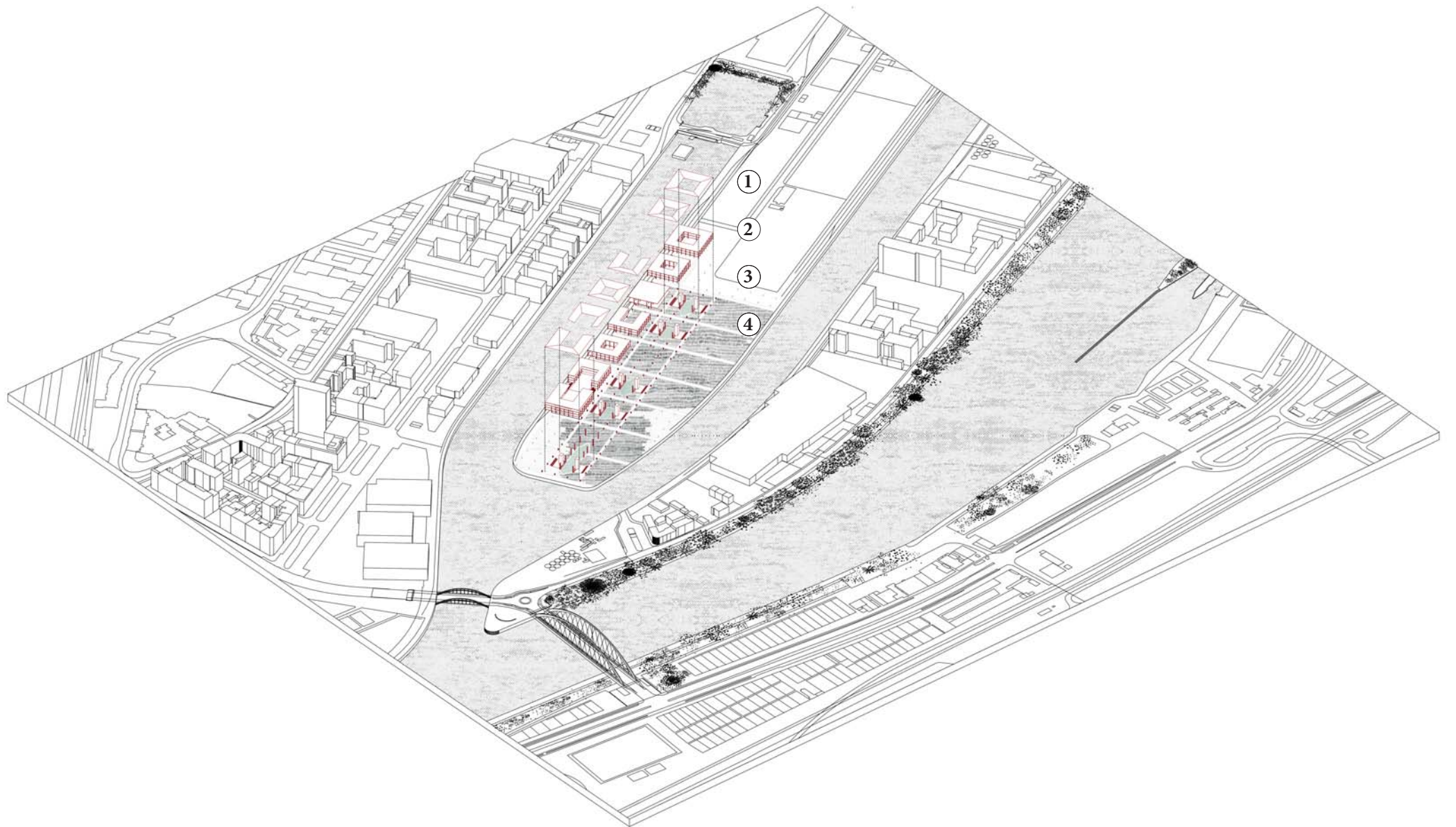

1. Toitures à impluvium
2. Composantes programmatiques
3. Fondations-crédation de zones humides
4. Biotopes alimentés par la récupération de l'eau de pluie

Territoires Exhumés/ Cour internationale de l'eau à Francfort sur Main

Laura Barbe

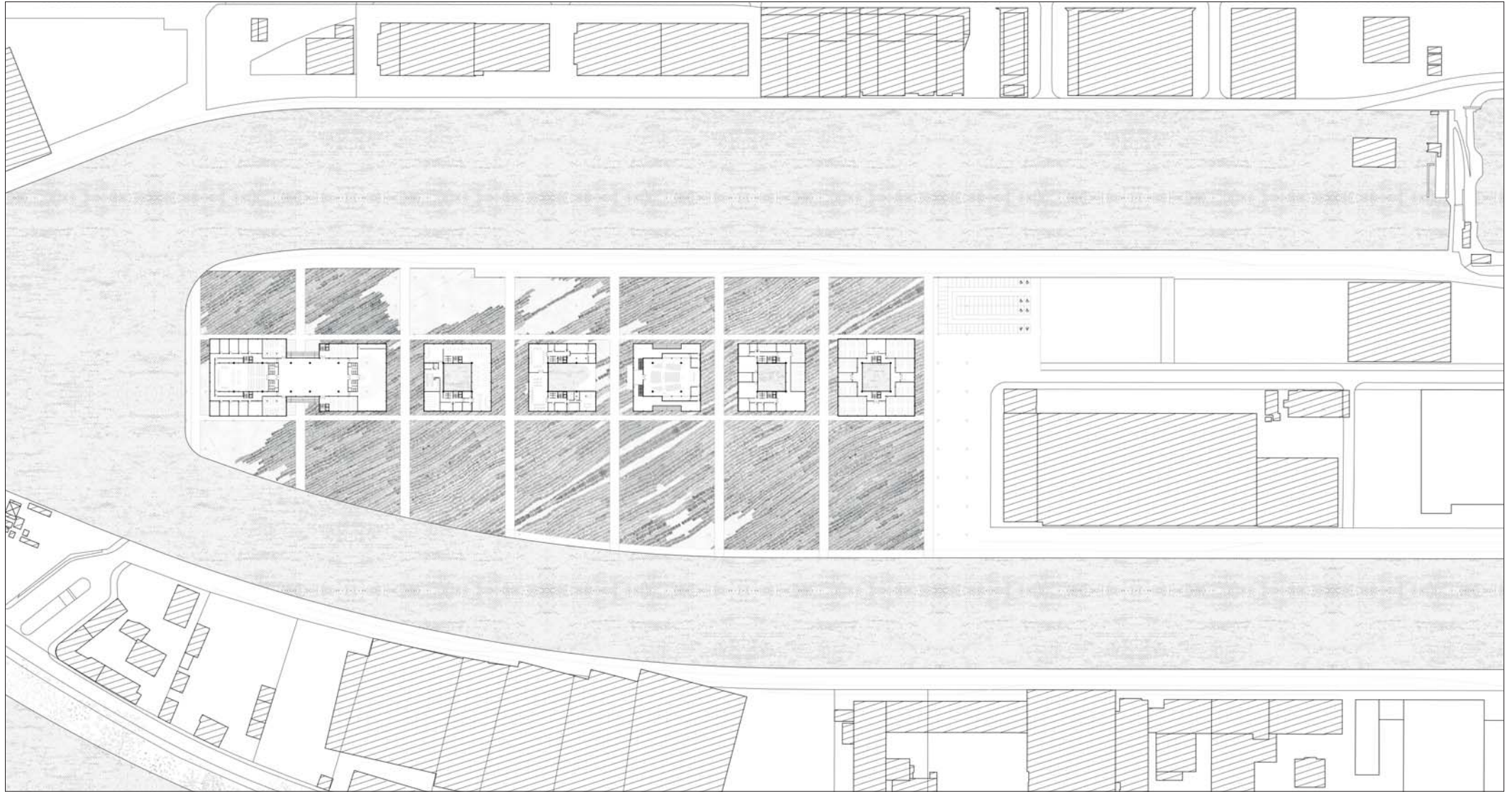

PLAN PAYSAGE RDC

1:1000

	PRINTEMPS	ETE	AUTOMNE	HIVER
1. PRAIRIES ET PELOUSE SECHE ET MESOPHILES Prairies mésophiles (<i>Arrhenatherum elatius</i>) Pelouses des sols acides (<i>Andropogon distachyus</i>) Pelouses alérophiles (<i>Arrhenatherum elatius</i> - <i>Festuca pratensis</i>)				
2. PELOUSES SECHES DES DUNES MOBILES Pelouses des dunes mobiles (<i>Spartina pectinata</i> - <i>Arrhenatherum elatius</i>) Végétation annuelle des hautes de plage (<i>Callitriche maritima</i>) Pelouses des brèves de galets et sables grossiers littoraux (<i>Arrhenatherum elatius</i> - <i>Elymus arvensis</i>)				
3. ROSELIERES Roselières d'eau douce (<i>Phragmites australis</i>) Roselières halophiles (<i>Scirpus compositus</i>) Herbiers littoraux des eaux mésohalines à eutrophes (<i>Scirpus compositus</i>)				
4. VEGETATION DES MARAIS SALES Graminées annuelles à éphémères (<i>Thymus</i> - <i>Scirpus spicatus</i>) Prairies des vases salées à <i>Spartina</i> (<i>Spartina patens</i>) Pâis sales (<i>Artemisia salina</i>) Fourrés bas des marais sales (<i>Artemisia salina</i>) Prairies oligohalines des hautes de marais sales (<i>Artemisia salina</i>)				
5. LANDES SECHES ET MESOPHILES Landes littorales (<i>Scirpus compositus</i> - <i>Urtica maritima</i>) Landes sèches de l'intérieur (<i>Urtica maritima</i>) Landes mésophiles de l'intérieur (<i>Urtica maritima</i> - <i>Elymus arvensis</i>)				
6. LANDES HUMIDES Landes humides (<i>Urtica maritima</i> - <i>Elymus arvensis</i>) Pelouses et prairies de bas-marais (<i>Arrhenatherum elatius</i> - <i>Callitriche maritima</i>) Prairies mésophiles (<i>Arrhenatherum elatius</i>)				
7. CULTURES Cultures (<i>Cerealia sativum</i> , <i>Urtica</i>) Communautés commensales des cultures (<i>Callitriche maritima</i>) Prairies mésophiles (<i>Arrhenatherum elatius</i>)				

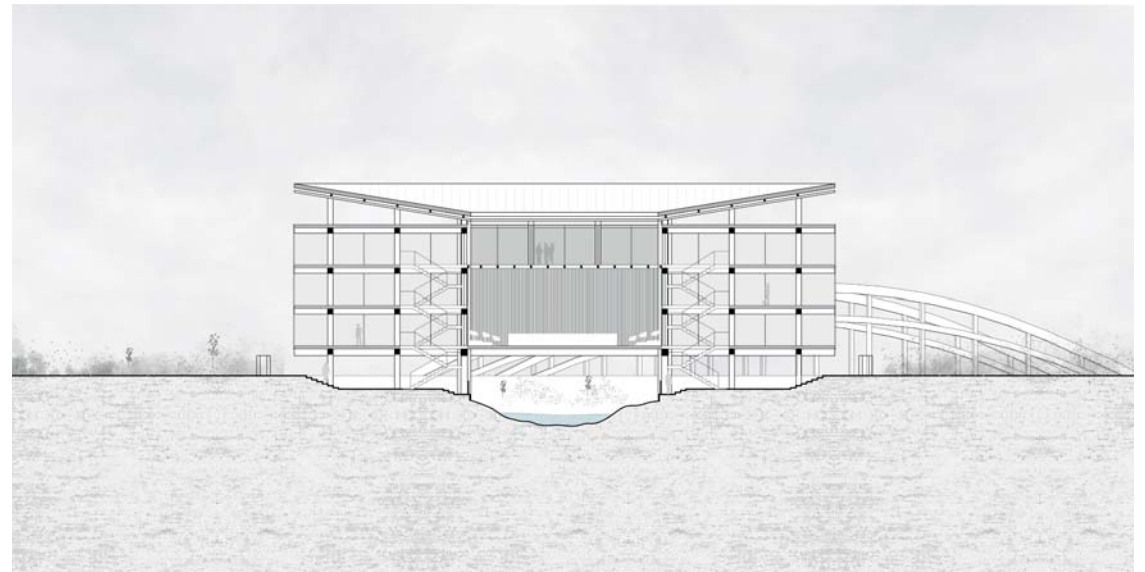
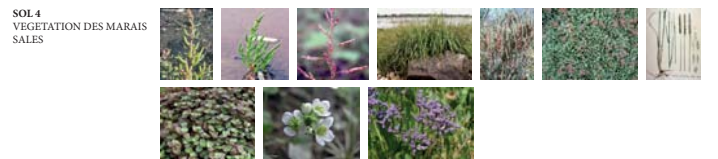
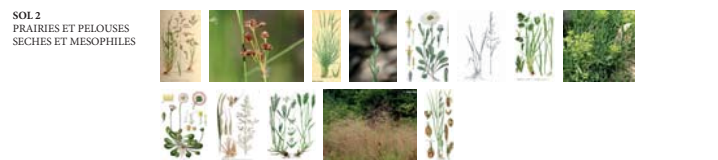
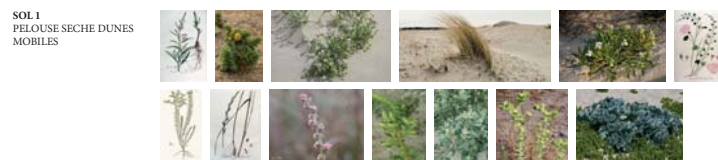

COUPE TRANSVERSALE 1

1:200

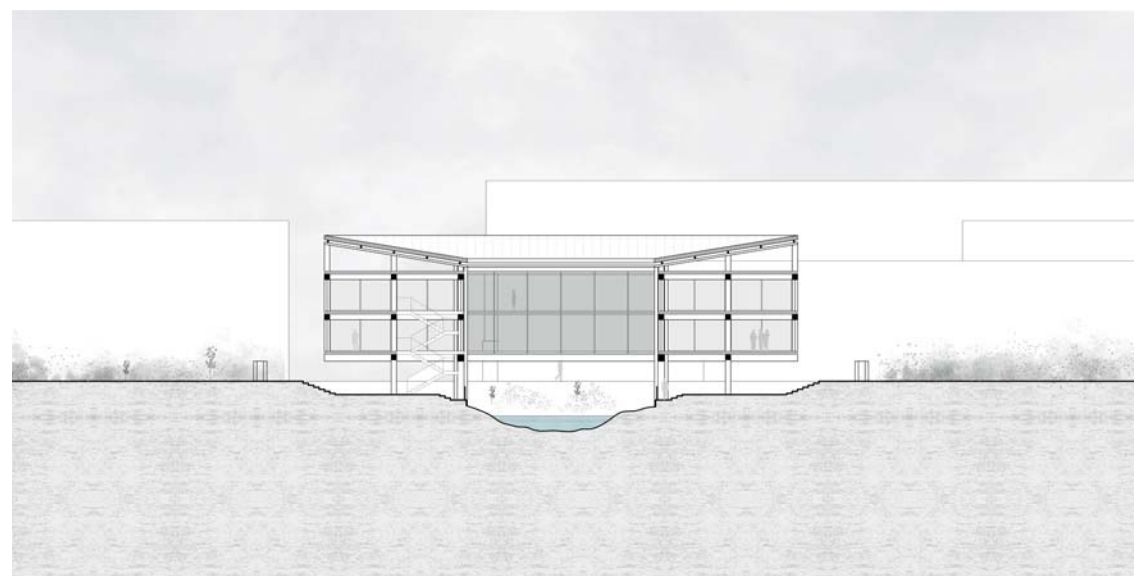

COUPE TRANSVERSALE 2

1:200

